

Decorating the Home



Room Proportions Affected by Decoration

THE Upholsterer has worked out this series of illustrations which shows in a striking way the truth of the generally recognized principle that vertical lines make anything seem taller while horizontal lines increase the appearance in width.

Nowhere is this principle more important than in interior decoration. A room with a very high ceiling, so high

it is, when a pronounced all-over pattern of wall paper is used. The spacious effect of a wall that is almost plain is shown in contrast.

It is stated that these two pictures were drawn from actual photographs of rooms in a New York apartment building where expense was unstinted. The building was new and in each case the room was decorated and furnished

wainscoting on the right, together with the vertical stripes of the wall paper increase the apparent height and for the majority of residences is much better than the other.

The over-generous use of heavy plate rails and other horizontal mouldings in rooms of nine foot ceilings becomes rather doubtful economy in the light of these tested principles of interior decoration.



Peace and Goodwill

A southern Missouri man was being tried on a charge of assault. The state brought into court as the weapons used, a rail, an axe, a pair of tongs, a saw and a rifle. The defendant's counsel exhibited as the other man's weapons a scythe-blade, a pitchfork, a pistol and a hoe.

The jury's verdict is said to have been: "Resolved, that, we, the jury, would have given one dollar each to have seen the fight."

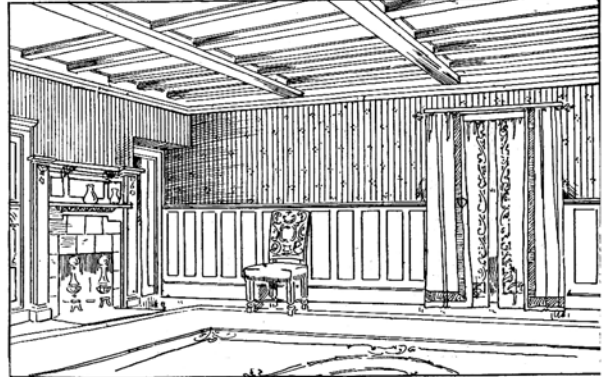
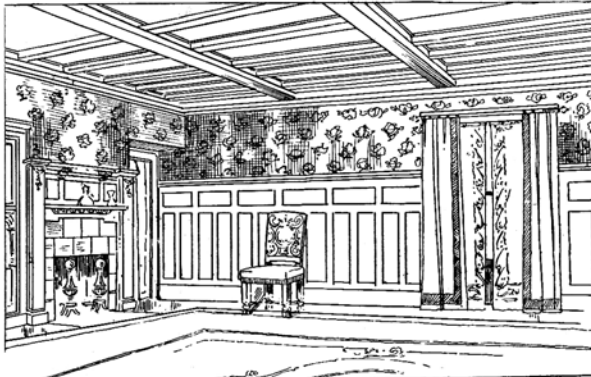

A Dining-room Treatment Showing Two Variations of Wainscoting. The High Wainscoting of the Illustration on the Left Reduces the Apparent Height of the Ceiling. The Low Wainscoting on the Right and the Vertical Stripes on the Wall Increase the Height.

that it seems bleak and cheerless, can be so decorated that the ceiling is brought down. Also decorators often want to make the ceilings of small rooms appear higher. They are able to accomplish this by doing away with horizontal lines.

One of these illustrations shows how a room is made to appear smaller than

for the first time so that the decorator had a perfectly free hand in laying out his scheme.

One of these groups gives an interesting study of the effect produced by a high paneled wainscoting, as in a dining room or reception hall. Unless the ceiling is very high it is not best to use such high panels. The low

He Knew!

"Perhaps you are familiar with the works of Ingersoll?" smilingly enquired the book agent as he reached under his coat for the sample bindings.

"Sure, I am," replied Mr. Goldberg, the jeweler; "undt it's a good vatch for der money!"

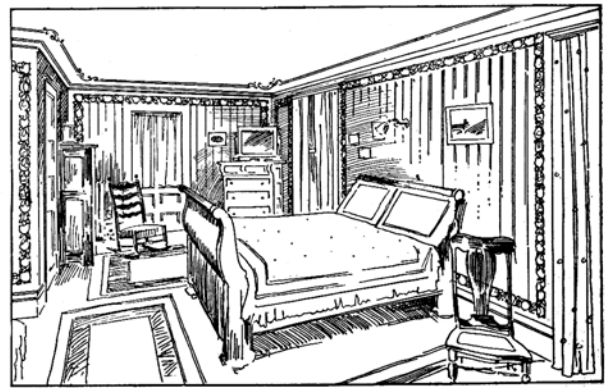
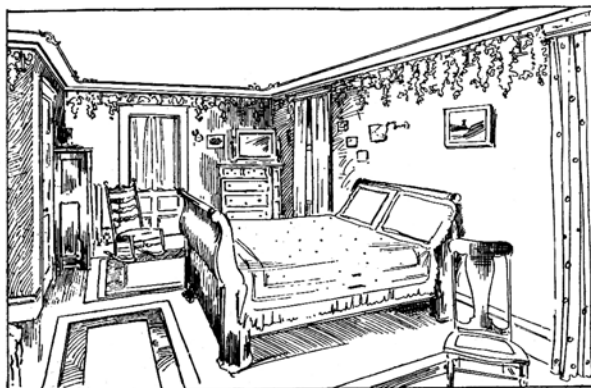

A Bedroom Comparison. The Furniture, Rugs and Ceiling Treatment is the Same in Each Case, but the Comparatively Plain Wall in the Left-hand Picture Gives a Much More Spacey Effect than is Possible with the Striped Walls on the Right.